

SEE ALSO  
B-4-81

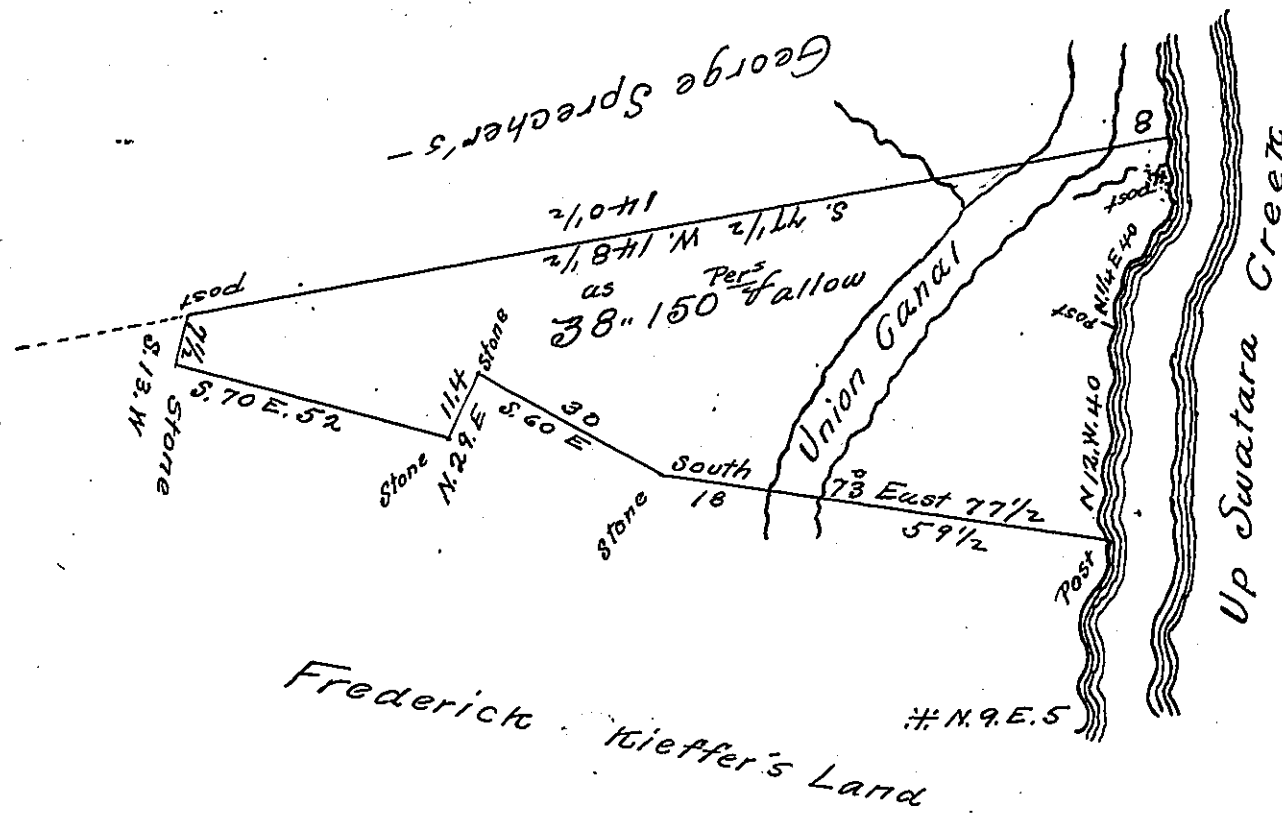

The above described tract of land situate in Hanover township in the County of Lebanon containing thirty eight acres & one hundred & fifty perches & allow. of 6 p<sup>cs</sup> & 6<sup>cs</sup>.

It being part of a larger tract of land of 404 acres & allow- by warrant dated the 8<sup>th</sup> day of June 1749. granted to Elizabeth & Thomas M<sup>o</sup> Cormick Survey<sup>d</sup> the 6<sup>th</sup> day of April 1829 by the request of Fred<sup>o</sup> Kieffer one of the Executors of his Father And<sup>o</sup> Kieffer dec<sup>d</sup>

Tob<sup>o</sup> Kreider Jr

Deputy Surveyor

IN TESTIMONY that the above is a copy of the original remaining on file in the Department of Internal Affairs of Pennsylvania, made conformably to an Act of Assembly approved the 16th day of February, 1833, I have hereunto set my Hand and caused the Seal of said Department to be affixed at Harrisburg, this ninth day of February 1906

*Goach R. Brown*  
Secretary of Internal Affairs.